

# Compact Zero Clearance Cabinet Installation

ZCC Part No. 225333

To suit Insert models: Opal SRS4, Riverina SRS3, Stockade SRS5, Barossa SRS3, Kimberley Mk2, Hamersley Mk2 Federation Mk2 & Victorian Insert

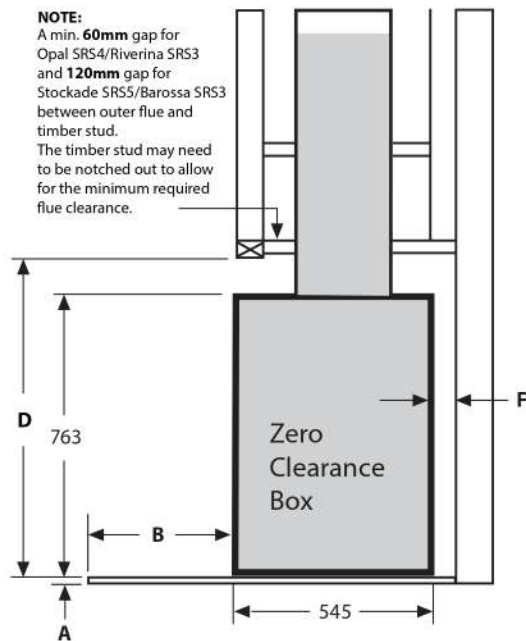
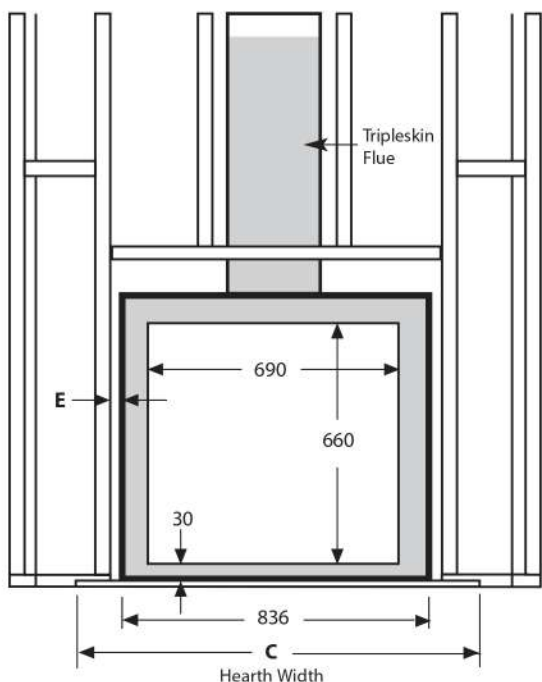

**NOTE:**  
A min. **60mm** gap for Opal SRS4/Riverina SRS3 and **120mm** gap for Stockade SRS5/Barossa SRS3 between outer flue and timber stud. The timber stud may need to be notched out to allow for the minimum required flue clearance.

Clearance to combustibles

All dimensions in millimetres, images not to scale

MODEL	A	B	C	D	E	F	G	H	I	J	Hearth depth mm in front of unit
Opal	12	570	890	810	40	20	1040	1100	50	250	530
Riverina	12	570	890	810	40	20	1040	1100	50	250	530
Stockade	12	550	950	810	40	20	1340	1390	50	250	510
Barossa	12	550	950	810	40	20	1340	1390	50	250	510
Kimberley	18	615	940	1063	100	50	1050	1140	25	250	550
Hamersley	18	705	1000	1063	100	50	975	1225	150	250	600
Federation	18	705	1000	1063	100	50	975	1225	150	250	600
Victorian	18	705	1000	1063	100	50	975	1225	150	250	600
See oversheet for dimensions.											

## Installation notes:

The Gason Zero Clearance Cabinet is an approved cabinet that allows for Eureka/Jindara Insert woodheaters as stated above to be installed within a non-masonry fireplace in accordance with AS2918:2001.

This can be achieved by following the installation guidelines listed below.

- Select the position that you wish to install your ZCC, carefully allowing for flue clearances of 305mm in the roof cavity (The outer flue being 255mm requires a 25mm clearance on either side to combustibles, making overall clearance 305mm).
- Place hearth (non-combustible cement sheet, villaboard or similar) in the position desired for the ZCC, ensuring hearth will extend fully underneath ZCC as shown above for relevant model. Place the ZCC into position.
- Fit flue upstands to the ZCC. Note: Line up centre holes with corresponding holes depending on model. Refer to diagram on sheet 2.
- Fit the flue to the upstands and terminate at the required height above the roof line.
- Fit 300mm x 100mm vermin proof vent directly behind where the ZCC will be located, as near as practicable to the floor. This vent will allow air access to the zero box either from another room or external air. Note, if installed on a timber floor, an additional two vents are required. i.e. Either through the floor, one each side of the zero box, or alternatively, through the side wall(s), if applicable.
- Build your frame around the ZCC maintaining the clearances listed above.
- Cover the front face of framing with a minimum 4mm cement sheet or non-combustible material.
- Cover the rest of the frame to suit your requirements with plaster, timber, MDF etc.
- Insert your chosen appliance into the zero cabinet. Note: x2 galvanized c-section brackets supplied are required to centralise Opal/Riverina, Stockade/Barossa. For installation of Kimberley, Hamersley, Federation and Victorian, appliances must sit on c-section to ensure correct installation height is achieved. Fit active flue and cowl once appliance is in position.
- Install the mantel if required. Note if mantel is made out of a combustible material the following dimensions must be adhered to.

All dimensions are minimum and must under no circumstances be reduced. A. F. Gason Pty Ltd accepts no liability whatsoever for their interpretation of AS2918:2001.

# Compact Zero Clearance Cabinet Installation

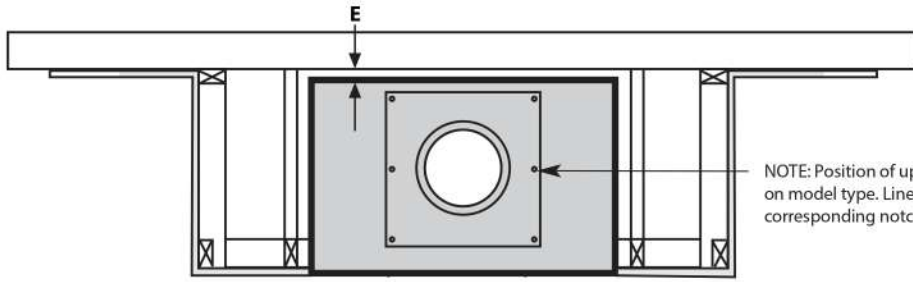

Barossa, Stockade & Kimberley Models

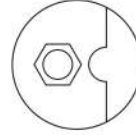

Opal & Riverina Models

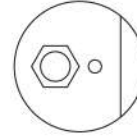

Hamersley Models

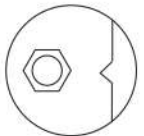

Victorian Insert & Federation Models

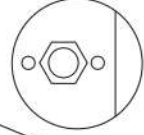

NOTE: Position of upstands on Zero Box differs depending on model type. Line up centre screw hole on Zero Box with corresponding notch on upstands.

## Step 1

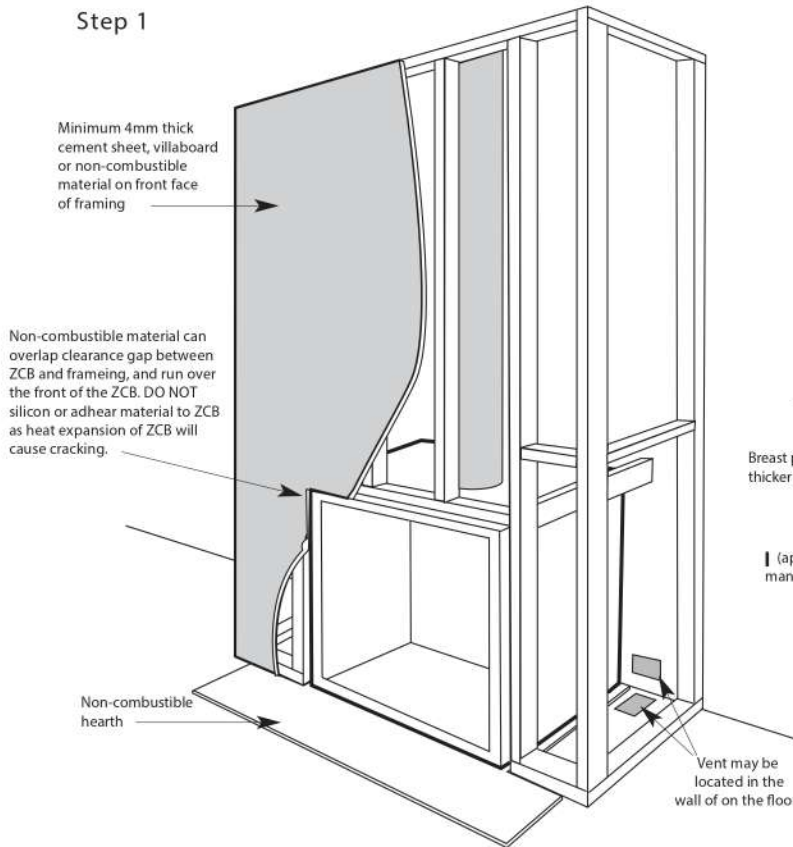

## Step 2

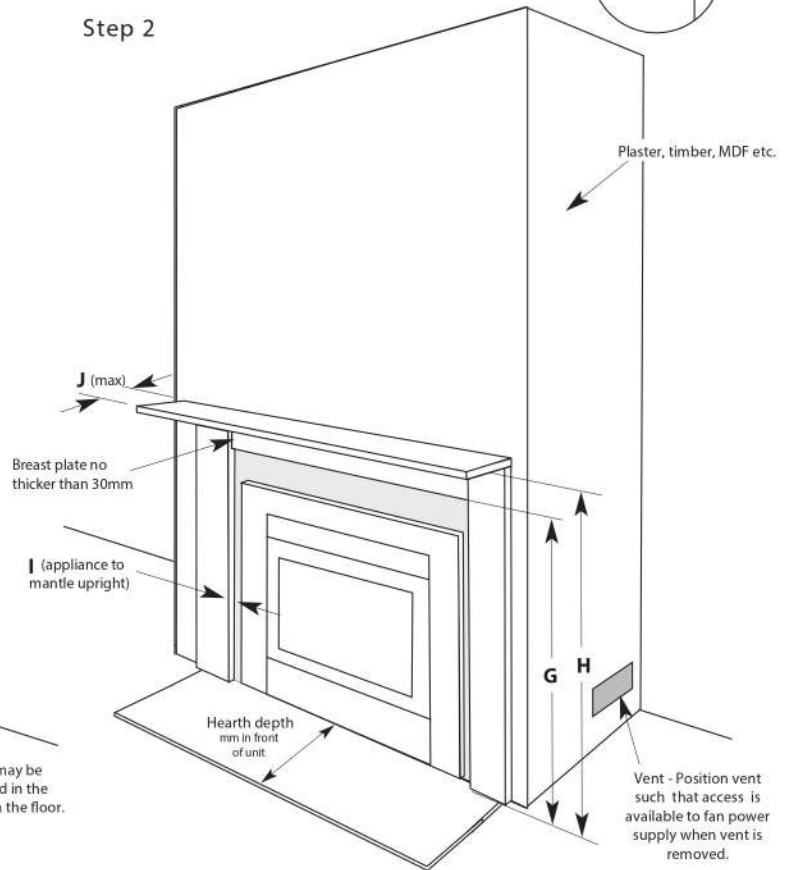

## 6 inch Flue Kit (Eureka & Jindara)

### Minimum Requirements:

- 5 x 6" S/S Flue
- 4 x 8" Gal Flue
- 4 x 10" Gal Flue

Note: Some states will use different size flue kits which will require the appropriate upstand.

### • 10" Upstands

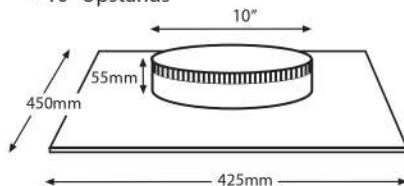

### • 8" Upstand

